

DF150P Series

Tech & Time System Co.,Ltd.

Tel:0-2529-6344 Email:sales@tech-time.co.th

Size : 294 x 235

Unit : mm

2-Speed: High and Low

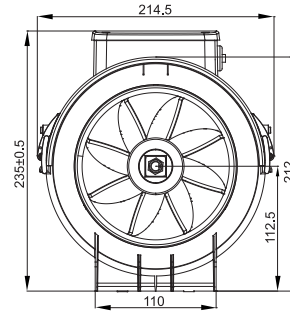
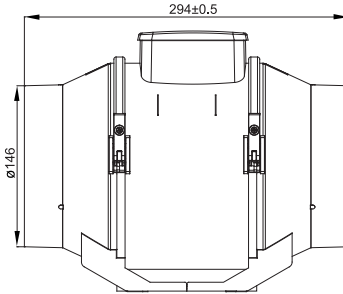

(Duct Fan)

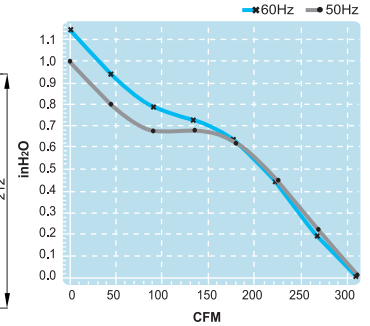

Thermal Protection



| Spec. | Rated Voltage | Frequency | Input Power | Rated Current | Locked Current | Speed | Maximum Air Flow | Maximum Air Flow | Maximum Pressure | Maximum Pressure | Noise | IP | Weight |
|------------|---------------|-----------|-------------|---------------|----------------|-------|----------------------|------------------|--------------------|----------------------|-------|------|--------|
| Model | V | Hz | W | A | A | RPM | m ³ /min. | CFM | mmH ₂ O | InchH ₂ O | dB | Rate | kg |
| DF150P11-H | 115V | 50 | 65 | 0.54 | 0.67 | 2000 | 8.5 | 300 | 26 | 1.02 | 62 | 44 | 2.6 |
| | | 60 | 75 | 0.65 | 0.68 | 1900 | 8.2 | 290 | 29 | 1.14 | 61 | 44 | |
| -L | 115V | 50 | 50 | 0.43 | 0.46 | 1400 | 5.7 | 200 | 19 | 0.75 | 53 | 44 | 2.6 |
| | | 60 | 52 | 0.46 | 0.47 | 1300 | 5.1 | 180 | 17 | 0.67 | 50 | 44 | |
| DF150P23-H | 230V | 50 | 65 | 0.27 | 0.32 | 2000 | 8.5 | 300 | 26 | 1.02 | 62 | 44 | 2.6 |
| | | 60 | 75 | 0.32 | 0.33 | 1900 | 8.2 | 290 | 29 | 1.14 | 61 | 44 | |
| -L | 230V | 50 | 50 | 0.21 | 0.23 | 1400 | 5.7 | 200 | 19 | 0.75 | 53 | 44 | 2.6 |
| | | 60 | 52 | 0.23 | 0.24 | 1300 | 5.1 | 180 | 17 | 0.67 | 50 | 44 | |